

ESTABLISHED 1927

Second Family

MATTHEW 28:19-20

BIBLE STUDY GUIDE

2024-2025 • WOODWAY CAMPUS

At Second Baptist Church, we are committed to creating community. The key to connecting is getting involved in a Bible Study class. Adult Bible Study is the heartbeat of the Second Family and is what gives our big church a friendly, small town feel.

Classes are designed with our diverse crowd in mind. You will find a class for every age – literally from birth to your final day on earth! Some classes are organized by age range and marital status, while others are for all ages and stages of life. Several are even taught in languages other than English.

In your class, you will have an opportunity to get involved in Small Groups, Women's and Men's Events, Service Projects, Mission Trips, Sports Leagues, and much more. You will discover that the class becomes your "Second" Family as you make wonderful friends and begin "doing life" together.

Our classes are free, there are no homework assignments or tests, and you will never be called on to read or pray aloud or answer questions without knowing in advance. Yet, our classes are designed to challenge you every week to grow in your faith. Whether you have never owned a Bible or hold a Master's Degree in Theology, come join us. You will be glad you did!

BIBLE STUDY

Sunday @ 8:15, 9:30 & 11AM | En Español Sunday @ 9:30AM

WORSHIP

Sunday @ 9:30AM & 11:11AM | Worship Center

SERVICIO EN ESPAÑOL

Sunday @ 11AM | Sanctuary

MISSION STATEMENT

Our goal is the same across the board: from the nursery to senior adults, we exist to make disciples – to lead people to Jesus Christ and help them grow in their relationship with Him. It is our goal to present the gospel to others in order to see the Holy Spirit change lives!

MISSION: THE GREAT COMMISSION

“Go therefore and make disciples of all the nations, baptizing them in the name of the Father and the Son and the Holy Spirit, teaching them to observe all that I commanded you; and lo, I am with you always, even to the end of the age.” Matthew 28:19-20

STRATEGY: EVANGELISM AND DISCIPLESHIP

“But you will receive power when the Holy Spirit has come upon you; and you will be My witnesses both in Jerusalem, and in all Judea and Samaria, and even to the remotest part of the earth.” Acts 1:8

PRODUCT: THE GOSPEL

“For I am not ashamed of the gospel, for it is the power of God for salvation to everyone who believes, to the Jew first and also to the Greek.” Romans 1:16

PROFIT: CHANGED LIVES

“Therefore if anyone is in Christ, he is a new creature; the old things passed away; behold, new things have come.” 2 Corinthians 5:17

WOODWAY | MAIN FL

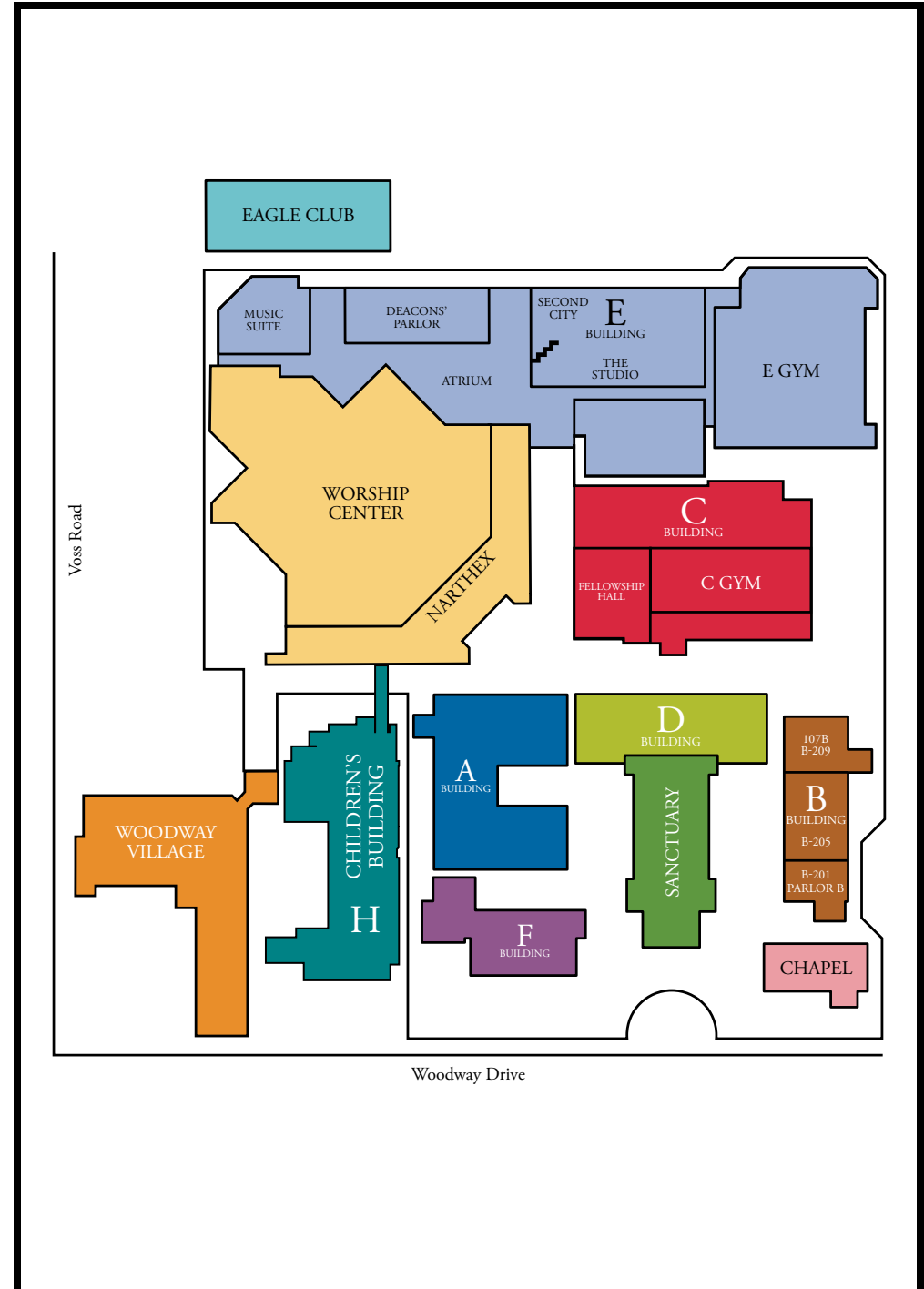

WOODWAY E BLDG

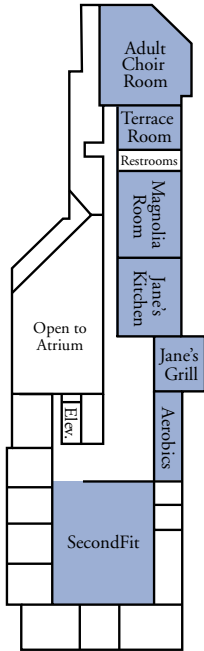

2ND FL

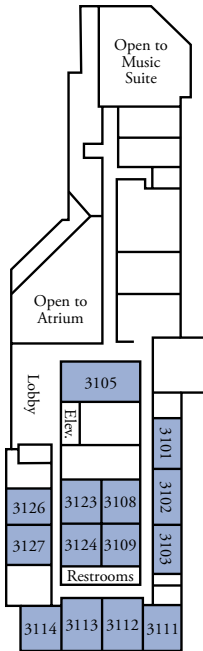

3RD FL

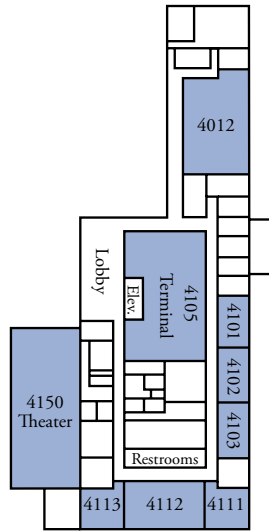

4TH FL

CHILDREN'S H BLDG

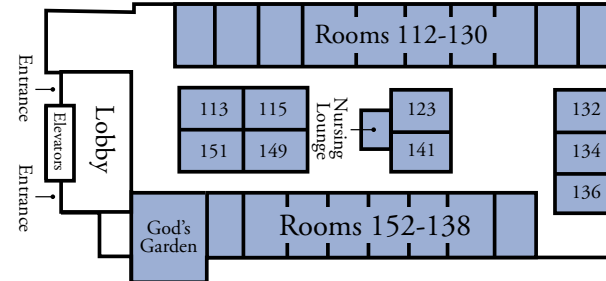

1ST FL
INFANTS & TODDLERS

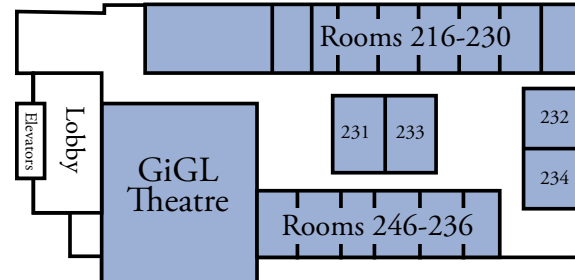

2ND FL
3YR-KINDERGARTEN

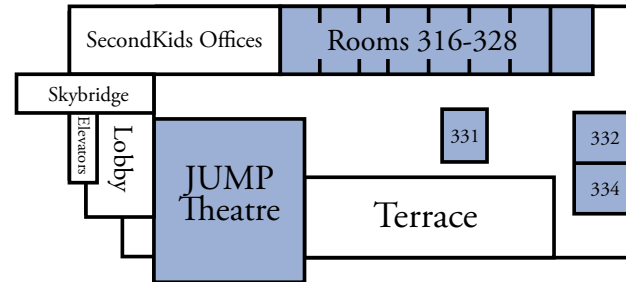

3RD FL
1ST-3RD GRADE

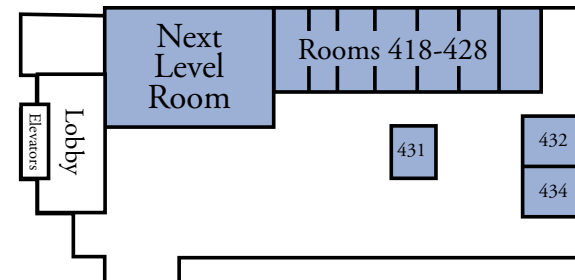

4TH FL
4TH & 5TH GRADE

WOODWAY VILLAGE

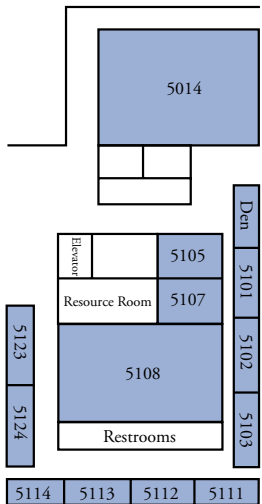
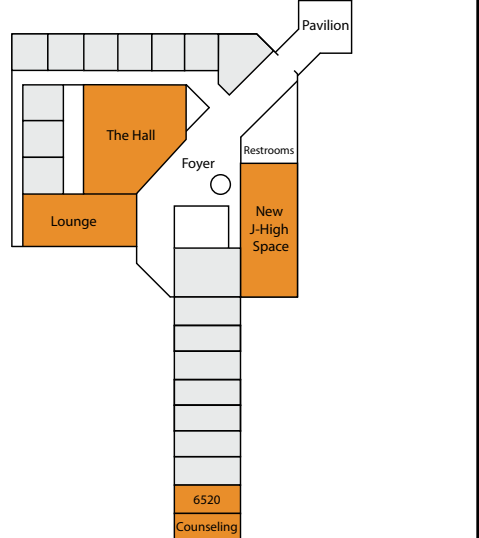

5TH FL

| Class | Division | Time |
|---------------------------------------------------------|-----------------------------------------------------------------------------------------------------------------------------------------------------------------------------------------------------------------------------------------------------------------------------------------------------------------------------------------------------------------------------------------------------------------------------------------------|-------------------------------|
| NURSERY | | |
| Nursery Care Check-in: 1st fl of Children's Building | Birth to 2 years (as of Sep 1, 2024) | Sunday 8:15AM, 9:30AM, & 11AM |
| | The Nursery Ministry is a great place for our littlest ones; it is a place where babies, toddlers, and parents feel comfortable. Each Bible story, song, and creative activity is intended to encourage a personal relationship with Jesus Christ. The health and safety of your little ones are primary concerns for us. Health polices are strictly enforced and full-time medical and security personnel are on call each hour. | |
| PRESCHOOL | | |
| Bible Study Check-in: 2nd fl of Children's Building | 3 years (as of Sep 1 2024) through Kindergarten | Sunday 8:15AM & 11AM |
| God's Garden Check-in: 2nd fl of Children's Building | 3's Worship | Sunday 9:30AM |
| GiGL Worship Check-in: 2nd fl of Children's Building | Pre-K & Kindergarten Worship | Sunday 9:30AM |
| | Preschool Ministry provides a safe, secure, and loving environment for preschool children ages 3 through Kindergarten. Children learn the Bible through hands-on activities, music, and crafts. Bible stories are taught in exciting ways that make Jesus alive and personal to each child. God's Garden and GiGL (Growing in God's Love) give Preschoolers a chance to enjoy Worship and Bible stories through puppets, music, and movement. | |
| | FOR MORE INFORMATION, CALL NURSERY 713.365.2344 OR PRESCHOOL 713.365.2343 | |

| Class | Division | Time |
|-------------------------------------------------------------------|--------------------------------------------------------------------------------------------------------------------------------------------------------------------------------------------------------------------------------------------------------------------------------------------------------------------------------------------------------------------------------------------------------|-----------------------------------------------|
| CHILDREN | | |
| Bible Study Check-in: 3rd fl of Children's Building | Grades 1-3 | Sunday 8:15AM Sunday 11AM |
| JUMP Worship Check-in: 3rd fl of Children's Building | Grades 1-4 | Sunday 9:30AM |
| | SecondKids provides a fun, safe, and loving environment for children (grades 1-3) to study the Bible, Worship, and meet new friends. Through Worship and age-appropriate curriculum, children learn how to have an awesome relationship with Jesus and how to live for Him each day. Outstanding teachers create a fun atmosphere where God's Word is brought to life in an exciting and creative way. | |
| NEXT LEVEL | | |
| Next Level Bible Study Check-in: 4th fl of Children's Building | Grades 4 & 5 | Sunday 8:15AM Sunday 9:30AM Sunday 11AM |
| Next Level Worship Check-in: 4th fl of Children's Building | 5th graders attend Worship with their parents. 4th graders have the option of attending JUMP or attending Worship with their parents. JUMP is on Sunday at 9:30AM. | |
| | Are you ready for the Next Level? We've created a ministry just for 4th and 5th graders. Crazy games, upbeat music, awesome leaders, and relevant teaching are only a few of the things you will experience after stepping through our doors. Come check us out on the 4th floor as we learn how to take our relationship with Christ to the Next Level. | |
| | FOR MORE INFORMATION, CALL SECONDKIDS 713.365.2341 | |

| Ministry | Location | Time |
|--------------------------|--------------------------------------------------------------------------------------------------------------------------------------------------------------------------------------------------------------------------------------------------------------------------------------------------------------------------------------------------------------------------------------------------------------------------------------------------------------------------------------------------------------------------------------------------------------------------------------------------------------|--------------------|
| JHigh: Grades 6-8 | Woodway Village - The JHigh Room | Sunday 9:30AM |
| High School: Grades 9-12 | Woodway Village - The Hall | Sunday 9:30AM |
| Second Students LIVE | Woodway Village | Wednesday 6:30-8PM |
| | At 8:15AM, Students (6TH-12TH Grade) meet in the H building GiGL theatre. At 11AM, Students (6TH-12TH Grade) meet in the Worship Center. | |
| | <p>JHIGH BIBLE STUDY (6TH-8TH GRADE) The JHigh Ministry eagerly seeks to build relationships with students. Our goal is not only to connect with students but also to assist with training and equipping them in the gospel of Jesus Christ. Come be a part of a fun and exciting community of JHigh students.</p> <p>HIGH SCHOOL BIBLE STUDY (9TH-12TH GRADE) The Second Students High School Ministry is all about life change. Every weekend, teenagers from across the city of Houston gather in Woodway Village to take part in Bible Study in a fun, relational environment.</p> | |
| | FOR MORE INFORMATION, CALL SECOND STUDENTS 713.365.2494 | |

PROMISE LAND

| Class | Division | Time |
|--------------------------------------------------------|---------------------------------------------------------------------------------------------------------------------------------------------------------------------------------------------------------------------------------------------------------------------------------------------------------------------------------------------------------------------------------------------------------------------------------------------------------------------------------------------------------------------------------------|------------------------------|
| PROMISE LAND | | |
| Promise Land Check-in: D Building, Rooms 101-104 | Ages 3+ | Sunday 8:15AM, 9:30AM & 11AM |
| | Promise Land exists to reach individuals with special needs, and their families, with the Good News of Jesus Christ. We desire for our participants to feel safe, loved and have the freedom to be themselves while in Promise Land. Our program allows them to grow emotionally, socially, and spiritually alongside others with special needs or disabilities. Promise Land allows families of those with special needs to connect to the life of the Second Family through Worship & Bible Study while their child is in our care. | |
| | APPLICATIONS MUST BE COMPLETED PRIOR TO DROP OFF. EMAIL LINDSEY SPENCER AT LSPENCER@SECOND.ORG FOR DETAILS. | |

WHY GO TO BIBLE STUDY?

Bible Study makes our big church feel like a friendly, small town community! You can make life-long friends in your class as you build relationships with one another, learn how to apply biblical principles to your everyday life, discover your gifts and talents, and serve together through volunteer projects and missions opportunities. Simply put, through Bible Study we experience life together as Christ followers and have FUN doing it!

WHAT DO YOU DO IN BIBLE STUDY CLASS?

Bible Study is all about exploring the amazing truths of the Bible in an age appropriate way within the context of community. Adults hear a biblically-based lesson with an emphasis on application while Second Students have a shorter lesson followed by small group time and activities. SecondKids is more interactive with every element emphasizing the Bible theme for that weekend. All of our teachers from Preschool to Adults present the Bible in an interesting and engaging way.

WHAT IF I HAVE NEVER BEEN TO A BIBLE STUDY BEFORE?

No problem! Adult classes have a lecture format and the environment is very welcoming. No one will call on you to speak unplanned or to pray out loud. Whether you are a Bible expert or have never read a verse before, just come as you are. Our staff and volunteers in Second Students and SecondKids work hard to make every student and child feel welcome and get connected to others in their class.

HOW DO I CHOOSE A CLASS?

Some classes are set up by age or stage of life. This is how SecondKids and Second Students are organized as well as some adult classes like Young Marrieds, Single Adults, or Español to name a few. Other classes are designated as "general," which means all ages and stages are welcome, or "topical" like the Nearlywed/Newlywed class. Look through this guide for the areas that apply to you and choose a class to visit or sign up at second.org/ministries by clicking the "contact us" box and completing the form. One of our staff will contact you to help you find the perfect class for you.

CAN I TALK WITH SOMEONE ABOUT ALL OF THIS?

Of course! Throughout this guide you will find contact information for different ministry areas. Give us a call or email us. We would love to tell you more and help you connect to the life of our church!

CLASSES BY BIBLE STUDY HOUR

SUNDAY 8:15AM | 9:30AM WORSHIP

| Class/Division | Age Range | Room | Director | Teachers |
|----------------|-----------------------------|---------------------------|----------------|---------------------------------------------------------------|
| All About Him | Ages 50+ | E 3113 | Jeff Deutsch | Chuck Gurney, Jay Klingenberg, Dena Houchin & Bob Moorman |
| Infusion | All Ages, Single or Married | B 107 | David Tauber | Lee Maxcy, Terry Womac, Diane McNeil & John Barksdale |
| New Beginnings | All Ages, Single or Married | Fellowship Hall C, 1st fl | Michael Harris | Kyle Parrish & Austin Gentry |
| Trinity | All Ages, Single or Married | B Parlor | Bob Blanchette | Myra Ray, Scott Ray, Bill Thomas & Perry Elders |
| Faithworks | Ages 50's-60's | Aerobics Room | Tom Baird | Jeff Calhoun & Randy Reimer |
| Fast Forward | Ages 20's-30's | E 4112 | Sam Long | Matthew Spencer, Lindsey Doyle & Jana Lohse |
| Genesis | Ages 50+ | E 5014 | John Meredith | L. Elsenbrook, C. Howard, C. McDaniel, D. Strake, & M. Taylor |
| Glory Days | Ages 40's-60's | Eagle Club, Athletic bldg | Rob Hungate | Jay Nylund, Rett Holiday & Elizabeth Carlyle |
| Legacy | Ages 20's-40's | E 3105 | Joey Jurkash | John Card, Willie Langston & Aaron Strassner |
| Rubicon | Ages 30's-40's | Studio E, 1st fl | Alex White | Drew Daniels & Brad Lane |
| The Truth | Ages 40's-60's | E 4012 | Curtis Weeks | Danny Havard, Art Prestage & Laura Kates |
| Cross Training | Ages 60+ | Magnolia Rm E, 2nd fl | Tom Wilcox | Reagan Sirmons & Paula Noble |
| Fresh Start | Ages 60+ | Deacons' Parlor E, 1st fl | Bob Reinhold | Tom Ramsey & Gary Moore |

SUNDAY 9:30AM | 11:11 WORSHIP

| Class/Division | Age Range | Room | Director | Teachers |
|-------------------------------------------------------------------|-----------------------------|---------------------------|-----------------|--------------------------------------------------------------------------|
| All In | Ages 40+ Single or Married | B 107 | James Bell | Nikki Corpening, & Curtis Bowman |
| Collide | All Ages, Single or Married | Fellowship Hall C, 1st fl | | Kevin Gamas & Bob Sweet |
| Nearlywed Newlywed (Engaged and First Year of Marriage) (Topical) | Ages 20-35 | E 4111 | Austin Green | Danny & Melinda Havard, Jeff & Liza Brown, Fred & Kellye Williams |
| STAND | All Ages, Single or Married | B Parlor | Kyle Haraughty | Priscilla Mahar, Dan Fritsch, John Parker, Melissa Cleveland & Teri Bono |
| Becoming | Ages 30's-40's | E 5114 | Marcus Northrup | Wes Lotz, Mark Nicoli & Jason Henry |
| CrossFit | Ages 30's-40's | E 4112 | Kyle Henry | Brad Chambers, Jared Flynn, Mitchell Frank & Julie Wiesen |
| Fixer Upper | Ages 40+ | Studio E, 1st fl | Jeff Kelly | Sam Glass, Tracy Wilkerson, Peggy Thompson & Chad Collins |
| Generation | Ages 30's-40's | Magnolia Rm E, 2nd fl | Ron Millard | Jon and Emily Goolsby, Donnie Boutwell & Rob Kwok |
| The Summit | Ages 20's-30's | E 5014 | Adam Unger | Clay Blaylock, Wes Yeary, Holly Gilbert & Ben Flanagan |

- GENERAL / TOPICAL
- YOUNG SINGLE ADULTS
- SINGLE ADULTS
- SINGLE PARENTS
- MARRIED
- ADULTS 60+
- INTERNATIONAL
- EN ESPAÑOL

SUNDAY 9:30AM | 11:11 WORSHIP

| Class/Division | Age Range | Room | Director | Teachers |
|----------------|-----------------------|----------------------------------------|---------------|---------------------------------------------------------------|
| Emerge | College Age: 18-22 | Jane's Grill - Thursday's 6:30PM | Josiah Osio | Caden Francis & Alek Moya |
| Emmaus | Ages 22-35 | Eagle Club Athletic Bldg | Zach Aube | David Velez, Taylor Anderson & Austin Gentry |
| SALT | Ages 30's-40's | B 205 | Tony Ochoa | Aaron Abraham-DeYang, Lindsay Rolph & Heath Blankenship |
| J.A.M. | Single Parents | B 209 | Jonathan Drum | Armando Garcia, Jason Hardy & Jerome Vielman |

| | | |
|------------------------------------------------------|----------------------------------------------------------|-----------------------------------------------------|
| ■ GENERAL / TOPICAL | ■ YOUNG SINGLE ADULTS | ■ SINGLE ADULTS |
| ■ SINGLE PARENTS | ■ MARRIED | ■ ADULTS 60+ |
| ■ INTERNATIONAL | ■ EN ESPAÑOL | |

SUNDAY 11AM | 9:30AM WORSHIP

| Class/Division | Age Range | Room | Director | Teachers |
|-------------------------------|--------------------------------|-----------------------------|--------------------|-------------------------------------------------------------------|
| New Song | All Ages, Single or Married | E 3123 | Tim Black | John Lyons & Cynthia Yzquierdo |
| Power House | Ages 45+ Single or Married | Studio E, 1st fl | Craig Flanagan | Ron Armstrong, Perry Elders, Kevin Kyle & Jan Richter |
| The Lodge | All Ages, Single or Married | 4150 Theater E, 4th fl | Bill Drennen | Jay Williams, Michael Brunner & Elizabeth Carlyle |
| The Way | Ages 30+ Single or Married | E 5114 | Jason Bozic | John Miranda, Nathan Cole, Angela Harless & Koren Dixon |
| TLC (Topical) | All Ages, Single or Married | E 4112 | John Sturman | Paul Bice & Delana Bice |
| Transformed | Women, All Ages | E 3124 | Carole Matthews | Beverly Gambrell & Dena Houchin |
| Eikon | Ages 22-35 | Eagle Club Athletic Bldg | Andrew Oakes | Clay & Nicole Blaylock & Taylor Anderson |
| Heights | Ages 60+ | E 4012 | Buddy Owens | Deanna Sullivan, Dan Leifker & Mark Miklos |
| Calibrate | Ages 30's-40's | E 5101 | Andrew Brown | Michael David & Tiffany Davis |
| Elevation | Ages 40's-50's | E 5014 | Bob Smith | Fred & Joanna Bakht, Will Davis & Steve Schaeffer |
| Union Station | Ages 30's-40's | E 5123 | Will Wilkes | Chad Ireton, Matt Eaglin & Brad Chambers |
| New Horizons | Ages 30's-50's | E 3105 | Nick Verburgt | Sean Boutros, Dave & Angel Taylor, Kyle Parrish |
| Base Camp | Ages 60+ | E 3105 | Jim Curtice | Bill Mearse & Pam Dollins |
| Fellowship Reunion | Ages 60+ | Terrace Rm E, 2nd fl | Carroll Kell | Bill Pielop, Scott Sheehan & Cynthia Hernandez |
| Firm Foundation | Ages 60+ | Aerobics Rm E, 2nd fl | Phil Dart | Chris Duell, Randy Mundt, Barbara Sundstrom & Tony Renteria |
| Holy Ground | Ages 60+ | Fellowship Hall | Roger Smith | Albert Butler, Diane Van Zandt Chambers & Jackie Bond |
| Sojourners | Ages 60+ | Deacons' Parlor | Vern Wilson | Gary Moore, Janet Cockrell & Tom Ramsey |
| Staying Alive | Ages 60+ | Magnolia Rm E, 2nd fl | JP Bowers | Barbara Durand, Mike Bryant & Kandy Brittain |

SPANISH

SUN 9:30AM | SUN 11AM WORSHIP

CLASSES BY DIVISION

GENERAL CLASSES

| Class/Division | Rango de edad | Room | Director | Teachers |
|----------------|---------------------------------|--------|-----------------|---------------------------------------------------------|
| Crece | Todas edades casados y solteros | E 5113 | Gerardo Vallejo | Carlos y Karla Fortín & Diana Vallejo |
| Renovación | Todas edades casados y solteros | E 5108 | Carlos Espinel | Vladimir Mercado, Rodolfo Rodriguez & Yuleida Hernandez |
| Resplandece | Todas edades casados y solteros | E 5124 | William Batz | Amado Medrano & Laura y Jose Buentello |
| Sígueme | Todas edades casados y solteros | Chapel | Raúl Calderón | Kevin y Surama Chavez, Sandra Puente & Kenys Martinez |
| Vencedores | Todas edades casados y solteros | E 5112 | Ruben Anastacio | Enrique Guardado, Omar Arvizo & Arturo Mata |
| | | | | |

| | | |
|------------------------------------------------------|----------------------------------------------------------|-----------------------------------------------------|
| ■ GENERAL / TOPICAL | ■ YOUNG SINGLE ADULTS | ■ SINGLE ADULTS |
| ■ SINGLE PARENTS | ■ MARRIED | ■ ADULTS 60+ |
| ■ INTERNATIONAL | ■ EN ESPAÑOL | |

| Class/Division | Age Range | Room | Director | Teachers |
|---------------------------------------------------------------------------------------------------------------------------------------------------------------------------------------------------|-----------------------------|---------------------------|-----------------|--------------------------------------------------------------------------|
| SUNDAY 8:15AM | | | | |
| All About Him | Ages 50+ | E 3113 | Jeff Deutsch | Chuck Gurney, Jay Klingenberg, Dena Houchin & Bob Moorman |
| New Beginnings | All Ages, Single or Married | Fellowship Hall C, 1st fl | Michael Harris | Kyle Parrish & Austin Gentry |
| Infusion | All Ages, Single or Married | B 107 | David Tauber | Lee Maxcy, Terry Womac, Diane McNeil & John Barksdale |
| Trinity | All Ages, Single or Married | B Parlor | Bob Blanchette | Myra Ray, Scott Ray, Bill Thomas & Perry Elders |
| SUNDAY 9:30AM | | | | |
| All In | Ages 40+ Single or Married | B 107 | James Bell | Nikki Corpening, & Curtis Bowman |
| Collide | All Ages, Single or Married | Fellowship Hall C, 1st fl | | Kevin Gamas & Bob Sweet |
| STAND | All Ages, Single or Married | B Parlor | Kyle Haraughty | Priscilla Mahar, Dan Fritsch, John Parker, Melissa Cleveland & Teri Bono |
| SUNDAY 11AM | | | | |
| New Song | All Ages, Single or Married | E 3123 | Tim Black | John Lyons & Cynthia Yzquierdo |
| Power House | Ages 45+ Single or Married | Studio E, 1st fl | Craig Flanagan | Ron Armstrong, Perry Elders, Kevin Kyle & Jan Richter |
| The Lodge | All Ages, Single or Married | 4150 Theater E, 4th fl | Bill Drennen | Jay Williams, Michael Brunner & Elizabeth Carlyle |
| The Way | Ages 30+ Single or Married | E 5114 | Jason Bozic | John Miranda, Nathan Cole, Angela Harless & Koren Dixon |
| Transformed | Women, All Ages | E 3124 | Carole Matthews | Beverly Gambrell & Dena Houchin |
| General classes are for anyone, no matter your age or stage of life! Come join a community of believers centered on Christ and desiring to serve one another, both inside and outside the church. | | | | |
| FOR MORE INFORMATION, CALL 713.365.3456 OR EMAIL JLOHSE@SECOND.ORG | | | | |

TOPICAL CLASSES

| Class/Division | Age Range | Room | Director | Teachers |
|------------------------------------------------------------------|--------------------------------------------------------------------------------------------------------------------------------------------------------------------------------------------------|--------|--------------|-------------------------------------------------------------------------|
| SUNDAY 9:30AM | | | | |
| Nearlywed Newlywed (Engaged and First Year of Marriage) | Ages 20-35 | E 4111 | Austin Green | Danny & Melinda Havard, Jeff & Liza Brown, Fred & Kellye Williams |
| SUNDAY 11AM | | | | |
| TLC | All Ages, Single or Married | E 4112 | John Sturman | Paul Bice & Delana Bice |
| | Topical classes are structured like general classes, but offer curriculum specific to their demographic, or that allows for a more in-depth study of Bible passages related to a specific topic. | | | |
| | FOR MORE INFORMATION, CALL 713.365.3456 OR EMAIL JLOHSE@SECOND.ORG | | | |

YOUNG SINGLE ADULTS

| Class/Division | Age Range | Room | Director | Teachers |
|--------------------|---------------------------------------------------------------------------------------------------------------------------------------------------------------------------------------------------------------------------------------------------------------------------------------------------------------------------------------------------------------------------------------------|-----------------------------|--------------|-------------------------------------------------|
| SUNDAY 9:30AM | | | | |
| Emmaus | Ages 22-35 | Eagle Club Athletic Bldg | Zach Aube | David Velez, Taylor Anderson & Austin Gentry |
| SUNDAY 11AM | | | | |
| Eikon | Ages 22-35 | Eagle Club Athletic Bldg | Andrew Oakes | Clay & Nicole Blaylock & Taylor Anderson |
| THURSDAY 6:30PM | | | | |
| Emerge | College Age: 18-22 | Jane's Grill | Josiah Osio | Caden Francis & Alek Moya |
| | Our Young Adult classes provide a place where you can develop meaningful friendships and learn more about God's purpose for your life. The life of a single adult is full of excitement, opportunity, and challenges; you don't have to experience it alone. Every week young singles just like you get together for classes, parties, recreation, mission trips and Worship. Come join us! | | | |
| | FOR MORE INFORMATION, CALL 713.365.2342 OR EMAIL MSPENCER@SECOND.ORG | | | |

SINGLE ADULTS

| Class/Division | Age Range | Room | Director | Teacher |
|----------------------|----------------------------------------------------------------------------------------------------------------------------------------------------------------------------------------------------------------------------------------------------------------------------------------------------------------------------------------------------------------------------------------|------------------|----------------|--------------------------------------------------------------------------|
| SUNDAY 8:15AM | | | | |
| Trinity | All Ages, Single or Married | B Parlor | Bob Blanchette | Myra Ray, Scott Ray, Bill Thomas & Perry Elders |
| SUNDAY 9:30AM | | | | |
| SALT | Ages 30's-40's | B 205 | Tony Ochoa | Aaron Abraham-DeYang, Lindsay Rolph & Heath Blankenship |
| STAND | All Ages, Single or Married | B Parlor | Kyle Haraughty | Priscilla Mahar, Dan Fritsch, John Parker, Melissa Cleveland & Teri Bono |
| All In | Ages 40+ Single or Married | B 107 | James Bell | Nikki Corpening, & Curtis Bowmans |
| SUNDAY 11AM | | | | |
| Heights | Ages 60+ | E 4012 | Buddy Owens | Deanna Sullivan, Dan Leifker & Mark Miklos |
| Power House | Ages 45+ Single or Married | Studio E, 1st fl | Craig Flanagan | Ron Armstrong, Perry Elders, Kevin Kyle & Jan Richter |
| The Way | Ages 30+ Single or Married | E 5114 | Jason Bozic | John Miranda, Nathan Cole, Angela Harless & Koren Dixon |
| | If you are single, over thirty-five and looking for a godly community then the Single Adult Ministry is just the place for you. Every weekend, hundreds of singles get together to meet new friends, study God's Word, and find life application in spiritual truths. Join us for events throughout the year including mission trips, retreats, sports leagues, parties and much more. | | | |
| | FOR MORE INFORMATION, CALL 713.365.2363 OR EMAIL AALVARENGA@SECOND.ORG | | | |

SINGLE PARENTS

| Class/Division | Age Range | Room | Director | Teachers |
|----------------------|-------------------------------------------------------------------------------------------------------------------------------------------------------------------------------------------------------------------------------------------------------------------------------------------------------------------------------------------|-------|---------------|----------------------------------------------|
| SUNDAY 9:30AM | | | | |
| J.A.M. | Single Parents | B 209 | Jonathan Drum | Armando Garcia, Jason Hardy & Jerome Vielman |
| | The Single Parent Ministry is a place for single parents to come, meet new friends, share challenges and triumphs and Worship God. The heart of this ministry is a commitment to seeing the lives of single-parent families change for the better through building relationships with Jesus Christ and with other single parent families. | | | |
| | FOR MORE INFORMATION, CALL 713.365.2363 OR EMAIL AALVARENGA@SECOND.ORG | | | |

MARRIED LIFE

| Class/Division | Age Range | Room | Director | Teachers |
|----------------------|-------------------------------------------------------------------------------------------------------------------------------------------------------------|---------------------------|-----------------|---------------------------------------------------------------|
| SUNDAY 8:15AM | | | | |
| Fast Forward | Ages 20's-30's | E 4112 | Sam Long | Matthew Spencer, Lindsey Doyle & Jana Lohse |
| Legacy | Ages 20's-40's | E 3105 | Joey Jurkash | John Card, Willie Langston & Aaron Strassner |
| Rubicon | Ages 30's-40's | Studio E, 1st fl | Alex White | Drew Daniels & Brad Lane |
| Glory Days | Ages 40's-60's | Eagle Club, Athletic bldg | Rob Hungate | Jay Nylund, Rett Holiday & Elizabeth Carlyle |
| The Truth | Ages 40's-60's | E 4012 | Curtis Weeks | Danny Havard, Art Prestage & Laura Kates |
| Genesis | Ages 50+ | E 5014 | John Meredith | L. Elsenbrook, C. Howard, C. McDaniel, D. Strake, & M. Taylor |
| Faithworks | Ages 50's-60's | Aerobics Room | Tom Baird | Jeff Calhoun & Randy Reimer |
| SUNDAY 9:30AM | | | | |
| The Summit | Ages 20's-30's | E 5014 | Adam Unger | Clay Blaylock, Wes Yeary, Holly Gilbert & Ben Flanagan |
| CrossFit | Ages 30's-40's | E 4112 | Kyle Henry | Brad Chambers, Jared Flynn, Mitchell Frank & Julie Wiesen |
| Becoming | Ages 30's-40's | E 5114 | Marcus Northrup | Wes Lotz, Mark Nicoli & Jason Henry |
| Generation | Ages 30's-40's | Magnolia Rm E, 2nd fl | Ron Millard | Jon and Emily Goolsby, Donnie Boutwell & Rob Kwok |
| Fixer Upper | Ages 40+ | Studio E, 1st fl | Jeff Kelly | Sam Glass, Tracy Wilkerson, Peggy Thompson & Chad Collins |
| SUNDAY 11AM | | | | |
| Calibrate | Ages 30's-40's | E 5101 | Andrew Brown | Michael David & Tiffany Davis |
| Elevation | Ages 40's-50's | E 5014 | Bob Smith | Fred & Joanna Bakht, Will Davis & Steve Schaeffer |
| Union Station | Ages 30's-40's | E 5123 | Will Wilkes | Chad Ireton, Matt Eaglin & Brad Chambers |
| New Horizons | Ages 30's-50's | E 3105 | Nick Verburgt | Sean Boutros, Dave & Angel Taylor, Kyle Parrish |
| | The Married Life Ministry seeks to help couples strengthen their marriages and build relationships with others while deepening their relationship with God. | | | |
| | FOR MORE INFORMATION, CALL 713.365.3456 OR EMAIL JLOHSE@SECOND.ORG | | | |

ADULTS 60+

| Class/Division | Age Range | Room | Director | Teachers |
|----------------------|------------------------------------------------------------------------------------------------------------------------------------------------------------------------------------------------------------------------------------------------------------------------------------------------------------------------------------------------------------------------|---------------------------|--------------|-------------------------------------------------------------|
| SUNDAY 8:15AM | | | | |
| Cross Training | Ages 60+ | Magnolia Rm E, 2nd fl | Tom Wilcox | Reagan Sirmons & Paula Noble |
| Fresh Start | Ages 60+ | Deacons' Parlor E, 1st fl | Bob Reinhold | Tom Ramsey & Gary Moore |
| SUNDAY 11AM | | | | |
| Base Camp | Ages 60+ | E 3103 | Jim Curtice | Bill Mearse & Pam Dollins |
| Fellowship Reunion | Ages 60+ | Terrace Rm E, 2nd fl | Carroll Kell | Bill Pielop, Scott Sheehan & Cynthia Hernandez |
| Firm Foundation | Ages 60+ | Aerobics Rm E, 2nd fl | Phil Dart | Chris Duell, Randy Mundt, Barbara Sundstrom & Tony Renteria |
| Heights | Ages 60+ | E 4012 | Buddy Owens | Deanna Sullivan, Dan Leifker & Mark Miklos |
| Holy Ground | Ages 60+ | Fellowship Hall | Roger Smith | Albert Butler, Diane Van Zandt Chambers & Jackie Bond |
| Sojourners | Ages 60+ | Deacons' Parlor | Vern Wilson | Gary Moore, Janet Cockrell & Tom Ramsey |
| Staying Alive | Ages 60+ | Magnolia Rm E, 2nd fl | JP Bowers | Barbara Durand, Mike Bryant & Kandy Brittain |
| | Still have adult children at home? Facing an empty nest? Caring for elderly parents? Each stage presents its own unique blessings and challenges as the Lord helps us deal with the constant change in our lives. The Adults 60+ Ministry provides an environment where all can grow in their relationship with God, and find support when dealing with common issues. | | | |
| | FOR MORE INFORMATION, CALL 713.365.2336 OR EMAIL SLISS@SECOND.ORG | | | |

INTERNATIONAL CLASSES

| Class/Division | Age Range | Room | Director | Teachers |
|---------------------------|-----------------------------------------------------------------------------------|----------|---------------|---------------|
| SUNDAY 12PM | | | | |
| Persians for Jesus Christ | Farsi Translation | E 3114 | Esmail Espari | Esmail Espari |
| SUNDAY 3PM | | | | |
| Bulgarian Class | Bulgarian Translation | B Parlor | Georgi Velev | Blaga Veleva |
| | FOR MORE INFORMATION, CALL 713.365.2363 OR EMAIL AALVARENGA@SECOND.ORG | | | |

CLASES EN ESPAÑOL

| Class/División | Rango de edad | Salón | Director | Maestros |
|------------------------|----------------------------------------------------------------------------------------------------------------------------------------------------------------------------------------------------------------------------------------------|---------------------------------------|-----------------|---------------------------------------------------------|
| DOMINGOS 9:30AM | | | | |
| Guardería | 0-2 años (antes o para el 1ro de sep, 2024) | Registración: 1er piso del Edificio H | | |
| God's Garden | 3 años | Registración: 2do piso del Edificio H | | |
| GiGL Worship | Pre-K & Kindergarten | Registración: 2do piso del Edificio H | | |
| JUMP Worship | Grados 1-4 | Registración: 3er piso del Edificio H | | |
| Next Level Bible Study | Grados 4 & 5 | Registración: 4to piso del Edificio H | | |
| JHigh | Grados 6-8 | Woodway Village - The JHigh Room | | |
| High School | 9-12 grados | Woodway Village - The Hall | | |
| Crece | Todas edades casados y solteros | E 5113 | Gerardo Vallejo | Carlos y Karla Fortín & Diana Vallejo |
| Renovación | Todas edades casados y solteros | E 5108 | Carlos Espinel | Vladimir Mercado, Rodolfo Rodriguez & Yuleida Hernandez |
| Resplandece | Todas edades casados y solteros | E 5124 | William Batz | Amado Medrano & Laura y Jose Buentello |
| Sígueme | Todas edades casados y solteros | Chapel | Raúl Calderón | Kevin y Surama Chavez, Sandra Puente & Kenys Martinez |
| Vencedores | Todas edades casados y solteros | E 5112 | Ruben Anastacio | Enrique Guardado, Omar Arvizo & Arturo Mata |
| DOMINGOS 11AM | | | | |
| Guardería | 0-2 años (antes o para el 1ro de sep, 2024) | Registración: 1er piso del Edificio H | | |
| Estudios Biblicos | 3 años (antes o para el 1ro de sep, 2024) hasta Kindergarten | Registración: 2do piso del Edificio H | | |
| Estudios Biblicos | Grados 1-3 | Registración: 3er piso del Edificio H | | |
| Next Level Bible Study | Grados 4 & 5 | Registración: 4to piso del Edificio H | | |
| | Al asistir a una clase formarás nuevas amistades y escucharás testimonios de vidas que Dios ha transformado mediante el estudio de su Palabra. Si deseas conocer el plan que Dios tiene para tu vida, te invitamos este domingo. ¡No faltes! | | | |
| | PARA MÁS INFORMACIÓN, LLAMA A SECOND EN ESPAÑOL 713.365.3453 OR EMAIL RCALDERON@SECOND.ORG | | | |

BIBLE STUDY INDEX

A

All About Him 15
All In 18

B

Base Camp 20
Becoming 19
Bulgarian Class 21

C

Calibrate 19
Children 7
Collide 15
Crece 22
Cross Training 20
CrossFit 19

E

Eikon 17
Elevation 19
Emerge 12
Emmaus 17
Estudio Bíblico para Niños 22

F

Faithworks 19
Fast Forward 19
Fellowship Reunion 20
Firm Foundation 20
Fixer Upper 19
Fresh Start 20

G

Generation 19
Genesis 19
GiGL 6
Glory Days 19
God's Garden 6
Guarderia 22

H

Heights 13, 18, 20
High School 8
Holy Ground 20

I

Infusion 15

J

J.A.M. 18
JHigh 8
JUMP 7

L

Legacy 19
LIVE 8

N

Nearlywed Newlywed 11, 16
New Beginnings 10, 15
New Horizons 13, 19
Next Level 7
New Song 15
Nursery 6

P

Persians for Jesus Christ 21
Power House 15
Preschool 6
Promise Land 8

R

Renovación 22
Resplandece 22
Rubicon 10, 19

BIBLE STUDY INDEX

S

SALT 18
Servicio para Niños 22
Second Students 8
Sígueme 22
Sojourners 20
STAND 15
Staying Alive 20

T

The Lodge 15
The Summit 19
The Truth 19
The Way 15
TLC 16
Transformed 15
Trinity 15, 18

U

Union Station 19

V

Vencedores 22



WOODWAY CAMPUS

6400 WOODWAY DRIVE | HOUSTON, TX | 77057
713.465.3408 | SECOND.ORG

©2024