

# Adult Bible Study Guide

Looking to build friendships and grow in your faith? Try Bible Study! It is where our big church becomes small. There's a group for every member of your family.

If you have never been to Bible Study before, don't worry. The environment is laid back. No one will call on you. Regardless of your experience with the Bible, you will feel right at home.

No reservation is required! Head to the blue banner at the north end of the main lobby. Our friendly volunteers will point you and your family in the right direction.

| Day     | Time                 | Attendees |           | Parents of |            |       | Class                        | Floor          | Room    |     |
|---------|----------------------|-----------|-----------|------------|------------|-------|------------------------------|----------------|---------|-----|
|         |                      |           |           | 0-5yrs     | Elementary | Teens |                              |                |         |     |
| Sundays | 8:30                 | Married   | 20's-40's | •          | •          | •     | Cultivate                    | 2              | 245     |     |
|         |                      |           | 30's-40's | •          | •          |       | Living Water                 | 2              | 243     |     |
|         |                      |           | 35-50     |            | •          | •     | Awake                        | 2              | 241     |     |
|         |                      |           | 50's-60's |            |            |       | Power Aid                    | 1              | 164     |     |
|         |                      | All       | 60+       |            |            |       | Cross Talk                   | 1              | 166     |     |
|         | 9:40                 | Married   | Single    | 30's-40's  | •          | •     | •                            | Elevate        | 2       | 243 |
|         |                      |           |           | 20's-30's  | •          | •     |                              | Multiply       | 1       | 180 |
|         |                      |           | •         |            | •          |       | Abide                        | 1              | 170     |     |
|         |                      |           | •         |            | •          |       | Mosaic                       | 1              | 150     |     |
|         |                      |           | •         |            | •          |       | GO!                          | 2              | 241     |     |
|         |                      |           | 30's-40's |            | •          | •     |                              | Dwelling Place | 2       | 240 |
|         |                      |           |           |            | •          | •     |                              | Anchored       | 2       | 245 |
|         |                      |           |           |            | •          | •     |                              | New Venture    | 1       | 164 |
|         |                      |           |           |            |            | •     |                              | Breakthrough   | 1       | 127 |
|         |                      |           | 40's-50's |            |            | •     |                              | Sold Out       | 1       | 160 |
|         |                      | 40's-60's |           |            |            |       | Overdrive                    | 2              | 244     |     |
|         |                      | All       | All Ages  | •          | •          | •     | Thirst                       | 1              | 166     |     |
|         | 11:00                | Single    | 20's      |            |            |       | Encounter                    | 2              | 245     |     |
|         |                      |           | 25-35     |            |            |       | Rise                         | 2              | 241     |     |
|         |                      | Married   | 50's-60's |            |            |       | Open Road                    | 1              | 127     |     |
|         |                      | All       | All Ages  | •          | •          | •     | Unidos (Español)             | 2              | 240     |     |
|         |                      |           |           | •          | •          | •     | Passport                     | 2              | 244     |     |
|         | Wednesdays at 6:30pm | All       | All Ages  | •          | •          | •     | Intermission (Topical Class) | 3              | HS Room |     |

Kids birth - 5th grade can go to *Shine*. JHigh and HS students can attend *LIVE*.

## FIRST FLOOR

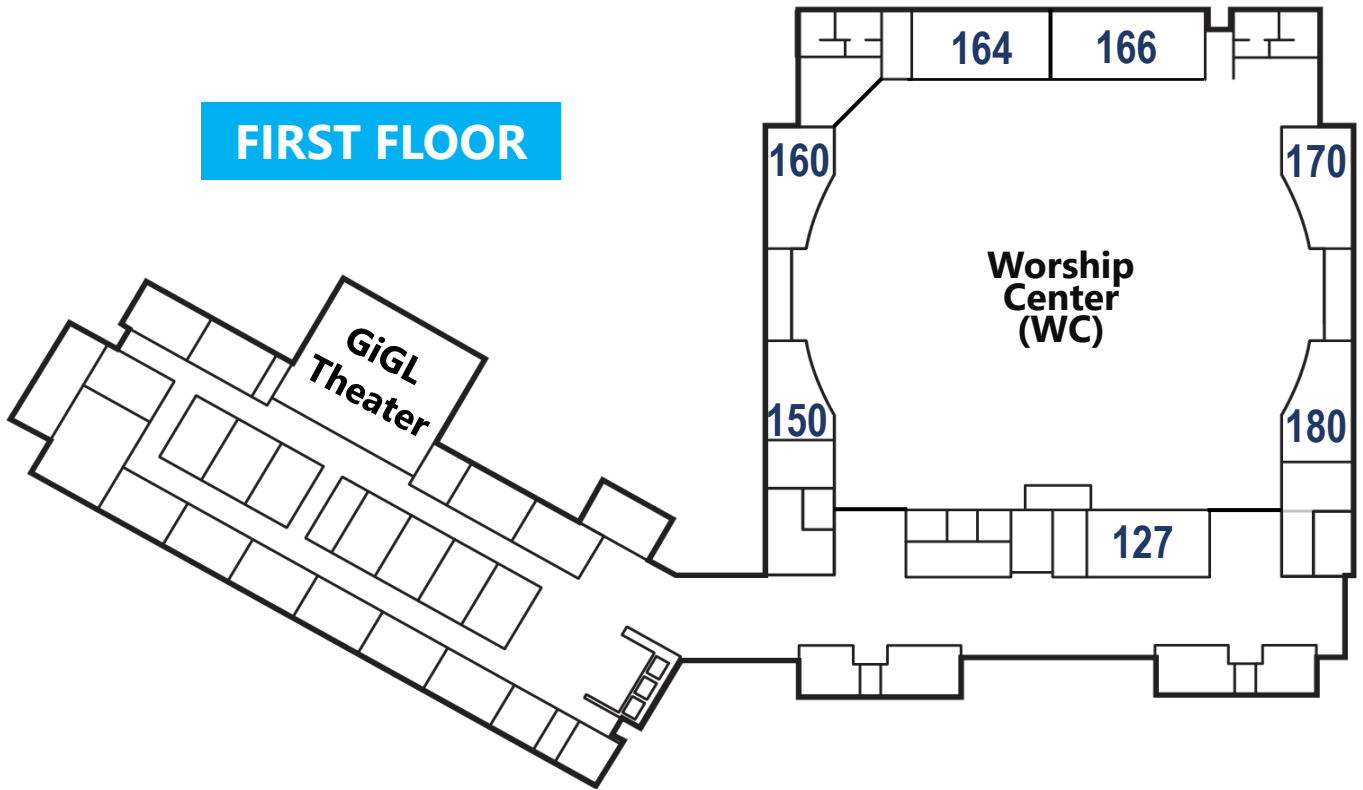

## SECOND FLOOR

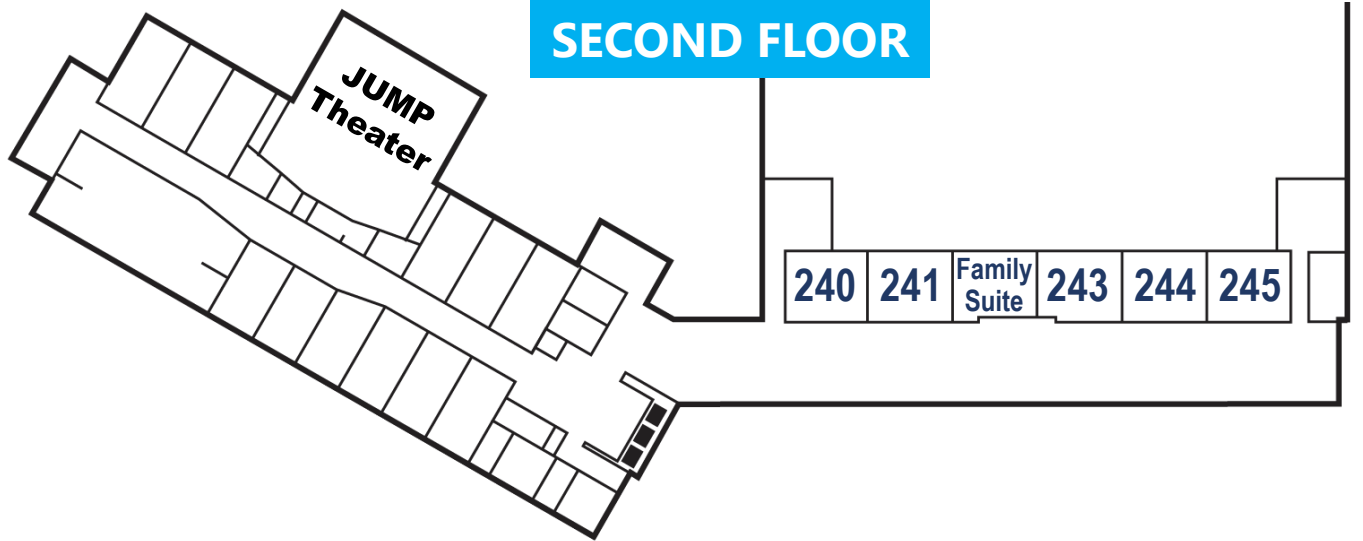

## Have Questions? Please reach out!

Kyle Leak  
Adult Ministries  
KLeak@second.org

Landon Church  
Second Kids  
LChurch@second.org

Jeremy Galasso  
Second Students  
JGalasso@second.org



1463 Campus  
5757 FM 1463, Katy TX, 77494

(713) 722-1850

www.second.org  
9.4.24